

The Hillcrest

Angelina Estates
2,333 Square Feet

The Hillcrest boasts an open floor plan complete with 2 ½ baths, an eat-in kitchen, a combined dining room and flex room, along with a spacious great room. Upstairs, the master bedroom features an incredible walk-in closet and a private bath. Three more bedrooms, a 2-car attached garage, and a basement complete this flexible home.



Architectural Style F



Architectural Style A - Included



Architectural Style D



6303 26 Mile Rd.
Suite 200
Washington, MI 48094

(888) 9-Lombardo

www.LombardoHomes.com



*All dimensions are approximate.
Artist rendering.*

The Hillcrest

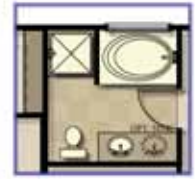

OPTIONAL DELUXE MASTER BATHROOM

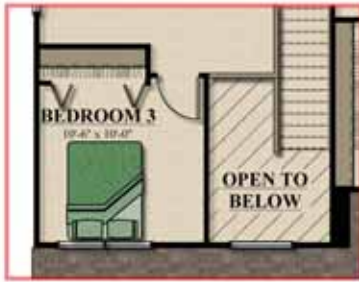

2 STORY FOYER
INCLUDED ON THE "F" ELEVATION ONLY



OPTIONAL ANGLED BAY



OPTIONAL FIREPLACE